



## VK-1320/WDDG1

1/3" B/W Dome Camera, In-Ceiling Mount with 4-8mm Varifocal Lens, 12VDC, 380TVL

Art-Nr. 91971



## Features

For Wall and In-ceiling Mount  
 Vandal and Tamper-Resistant  
 Clear Lexan Bubble with Inner Liner  
 B&W CCD Board Camera with Manual Varifocal Lens  
 1/3" CCD Sensor  
 Resolution of 380 Horizontal Lines

Automatic Shutter Control (AES)  
 Automatic Gain Control (AGC)  
 Back Light Compensation (BLC)  
 Integrated F1.6/4-8mm Varifocal Lens  
 For Easy Indoor Installation

## Specifications

Gain control	Automatic
Signal-to-noise ratio	46dB (AGC OFF)
Automatic shutter control (AES)	1/50 to 1/100,000sec.
Horizontal angle of view	Approx. 63°-34°
Cable connection	Video (BNC), 12VDC (DC jack)
Protection rating	IP50 (at installation according to the manual)
Parts supplied	Mounting kit, Torx wrench key
Bubble	Vandal resistant 3mm clear polycarbonate bubble with inner liner
Cable entry	2x 8mm holes with rubber glands
Housing	Die-cast aluminium with clear polycarbonate bubble
Video output	1Vp-p, VBS, 75ohms
Temperature range	-10°C to +45°C
System	CCIR/PAL
Synchronization	Internal
Lens	F1.6-2.4/4-8mm (fixed iris)
Power consumption	Approx. 2.0watts
Horizontal resolution	380 TV lines

## VK-1320/WDDG1

(Specifications continued)

<b>Weight</b>	Approx. 750g
<b>Backlight compensation (BLC)</b>	60% center weighted
<b>Gamma correction</b>	0.45
<b>Sensitivity at 50% video signal</b>	0.3Lux at F2.0 (VT measurement result); 0.14Lux at F1.2
<b>Supply voltage</b>	12VDC (+/-10 %)
<b>Imager</b>	1/3" Sony Super HAD Interline Transfer CCD
<b>Active picture elements</b>	Approx. 300,000 (H) 512 x (V) 582 pixels
<b>Dimensions (HxWxD)</b>	See drawing

## Accessories

<b>70447 / VT-PS12DC-5</b>	Plug-in Power Supply 100-240VAC/12VDC
<b>77772 / VT-PS12DCDT</b>	PSU 12VDC/0,5A, Desktop version

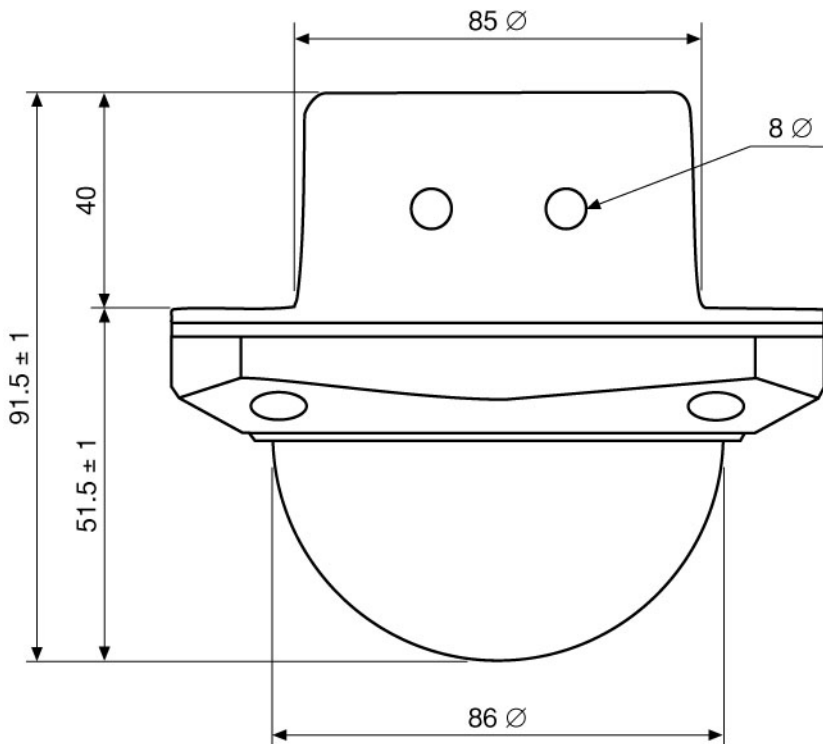
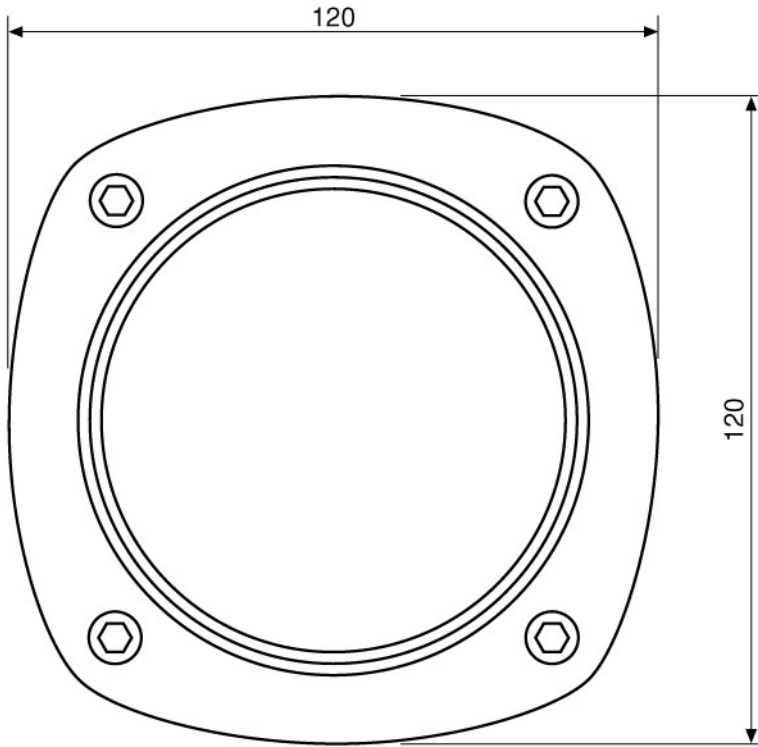

Maße/Dimensions: mm

SLD Security & Communications  
 The Old Forge, Ockham Lane, Ockham, Surrey GU23 6PH England  
 Phone +44.1483225633 · Fax +44.1483225634  
 sales@sld.co.uk · www.sld.co.uk

