

# VKCD-1321SSM/MF

Home | Security | Dome Cameras | Fixed

VKCD-1321SSM/MF  
1/3" Colour Minidome, Surface Mount, F2.0/3.6mm,  
540TVL, 12VDC, Silver

Art-Nr. 92159



SLD Security & Communications

## Main Features

For Wall and Ceiling Surface Mount  
Vandal Resistant  
1/3" Colour Board Camera with Super HAD CCD  
Integrated Lens F2.0/3.6mm  
Resolution of 540 Horizontal Lines  
Automatic Shutter Control up to 1:100,000Sec.

Digital Signal Processing (DSP)  
Automatic White Balance (ATW)  
Silver-coloured Aluminium Die-cast Casing  
Clear Lexan Bubble, 57mm  
For Easy Indoor and Outdoor Installation (IP66)

## Specifications

Video standard	PAL
System	Colour
Sensor size	1/3"
Imager	CCD, Sony Super HAD Interline Transfer
Active picture elements	440,000, 752(H) x 582(V)
Synchronization	Internal
Signal-to-noise ratio	48dB
Sensitivity (at 50% video signal)	0.84Lux at F1.2 (Videor measurement result including bubble)
Horizontal resolution	540 TVL
Rotation range	360°
Automatic gain control (AGC)	Included
Gamma correction	approx. 0.45
High-speed shutter (ESC)	1/50 ~ 1/100,000sec.
Integration rate	no
Digital Noise Reduction (DNR)	no
White balance (AWB)	Automatic control

# VKCD-1321SSM/MF

(Continuation Specifications)

<b>Backlight compensation</b>	BLC
<b>Aperture Correction (APC)</b>	Horizontal and vertical
<b>IR cut filter</b>	standard
<b>Video outputs (type)</b>	CVBS
<b>Video outputs</b>	1Vp-p, CVBS, 75ohms
<b>Lens mount</b>	integrated lens
<b>Lens type</b>	fixed focal length
<b>Lens</b>	F2.0/3.6mm
<b>Aspherical technology</b>	no
<b>Focal length</b>	3,6 mm
<b>Horizontal angle of view</b>	68°
<b>Iris control</b>	no
<b>MOD (Minimum object distance)</b>	0,1 m
<b>Filter screw size</b>	not available
<b>Cable connection</b>	Video (BNC), 12VDC (DC jack)
<b>Serial interfaces</b>	no
<b>Temperature range (Operation)</b>	-10° ~+50°C
<b>Heater</b>	no
<b>Protection rating</b>	IP66, at installation according to the manual
<b>Supply voltage</b>	12VDC, 10 ~14VDC, 12VDC ±0,5V recommended
<b>Power consumption</b>	2.0W max.
<b>Vandalism resistant</b>	yes
<b>Bubble</b>	57mm (2.25"), clear polycarbonate plastic
<b>Colour (bubble)</b>	clear
<b>Camera adjustment</b>	3-axis camera adjustment: 360° horizontal rotation / +-45° tilt rotation, 360° pan rotation
<b>Camera fixing</b>	no
<b>Mounting</b>	surface mount, wall mount
<b>Housing</b>	Outdoor
<b>Housing material</b>	Aluminium
<b>Colour (housing)</b>	silver grey
<b>Dimensions (HxWxD)</b>	See drawing
<b>Weight</b>	170g
<b>Certificates</b>	CE

## Optional accessories

<b>77773</b>	<b>VT-PS12DCDT1</b>	PSU 12VDC/1.0A, Regulated, Desktop Version, 1.8m Cables each w. open ends
<b>70495</b>	<b>VT-PS12DC-7</b>	Plugable PSU w. Cont. & UK Mains plug-in 100-240VAC/12VDC-1.25A, Regulated

# VKCD-1321SSM/MF

70535

VT-PS12DC-8

Plug-in Power Supply Unit 100-240VAC 12VDC (1.0Amp), Regulated,  
with DC Plug

# VKCD-1321SSM/MF

Home | Security | Dome Cameras | Fixed

## Technical drawing

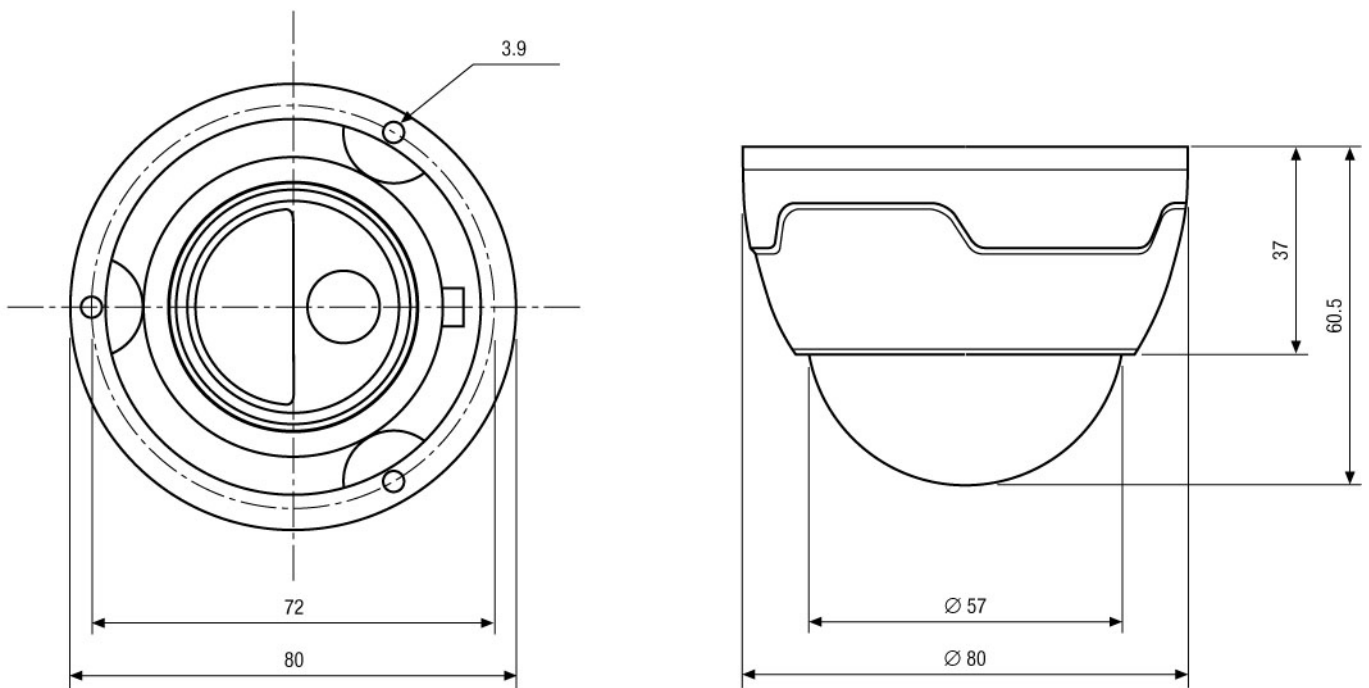

Maße/Dimensions: mm

SLD Security & Communications  
The Old Forge, Ockham Lane, Ockham, Surrey GU236PH England  
Phone +44.1483225633 · Fax +44.1483225634  
sales@sld.co.uk · www.sld.co.uk

