

# CG-832PA1V

Home | Security | Cameras | Boxed

CG-832PA1V  
1/3" Colour Camera, DSP, AGC, APC, BLC, ESC, AWB,

540TVL, 230VAC

**Art-Nr. 92512**



Lens not included

## Main Features

<b>Resolution of 540 Horizontal Lines</b>	<b>Horizontal and Vertical Aperture Correction (APC)</b>
<b>Automatic Gain Control (AGC)</b>	<b>Integrated Eclipse and Flickerless Function</b>
<b>High Sensitivity of 0.4Lux (at F1.2)</b>	<b>Automatic White Balance with Hold Function (AWB)</b>
<b>Back Light Compensation (BLC)</b>	<b>Auto Blemish Compensation (up to 32 Pixels)</b>
<b>Electronic Shutter Control (ESC)</b>	<b>Adjustable Video Transmission Distance</b>
<b>Automatic AI/DC Control Selection (Depend on Lens)</b>	<b>Supply Voltage: 230VAC</b>

## Specifications

<b>System</b>	colour
<b>Video standard</b>	CCIR/PAL
<b>Sensor size</b>	1/3"
<b>Imager</b>	CCD, Sony Super HAD Interline Transfer
<b>Active picture elements</b>	440,000, 752(H) x 582(V)
<b>Horizontal resolution</b>	540 TVL
<b>Synchronization</b>	Internal/AC line lock
<b>Signal-to-noise ratio</b>	48dB (AGC OFF)
<b>Gamma correction</b>	0.6/1.0
<b>Sensitivity (at 50% video signal)</b>	0,4 Lux, at F1.2 (measured)
<b>Low speed shutter</b>	no
<b>Digital Noise Reduction (DNR)</b>	no
<b>Backlight compensation</b>	BLC, eclipser, ON/OFF switchable

# CG-832PA1V

(Continuation Specifications)

<b>Wide Dynamic Range (WDR)</b>	no
<b>White balance</b>	automatic/manually
<b>Blemish compensation</b>	Automatic blemish detection and compensation (for up to 32 pixels)
<b>Aperture Correction (APC)</b>	horizontal and vertical
<b>Flickerless function</b>	120sec., ON/OFF switchable
<b>IR cut filter</b>	standard
<b>OSD function control</b>	OSD camera setup, Pixel correction, Eclipser, BLC, AWB, Chroma, ESC, AGC, Flickerless, Aperture, Masking (Window blanking), Transmission distance compensation
<b>Digital zoom</b>	no
<b>Lens mount</b>	CS mount
<b>Iris control</b>	Manual iris, Auto-Iris/DC controlled
<b>Auto exposure</b>	Automatic/Manual/flimmerfree/AGC
<b>External adjustments</b>	Flange focus Switch for setup menu
<b>Video outputs</b>	composite (CVBS), 1Vp-p, 75ohms, BNC
<b>External connections</b>	DC Iris control (4 pin), Video (BNC), Power input
<b>Serial interfaces</b>	no
<b>Camera mount</b>	1/4" - 20 UNC thread on top and bottom
<b>Supply voltage</b>	230VAC
<b>Power consumption</b>	approx. 12watts
<b>Temperature range (operation)</b>	-10°C ~+50°C
<b>Dimensions (HxWxD)</b>	see drawing
<b>Weight</b>	400g
<b>Parts supplied</b>	4 pin Lens plug, Allen wrench key, Control adapter cable with open ends, Quick start guide and manual on CD
<b>Certificates</b>	CE

## Optional accessories

70769	WD-22	Wall Mount Bracket with Ball Joint, 1/4" Camera Fixing Screw, Beige Grey
43106	C/CS RING-AL	Adapter Ring, C/CS Mount, Aluminium anodized
70771	WD-23	Wall Mount Bracket with Ball Joint, 1/4" Camera Fixing Screw, Pantone 877

# CG-832PA1V

Home | Security | Cameras | Boxed

## Technical drawing

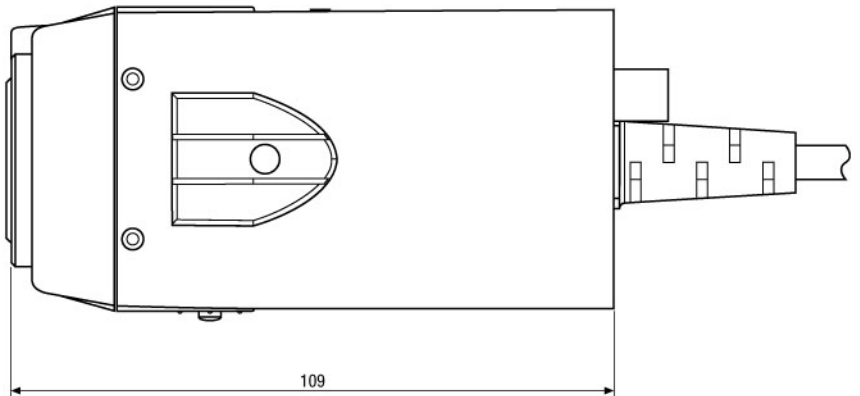
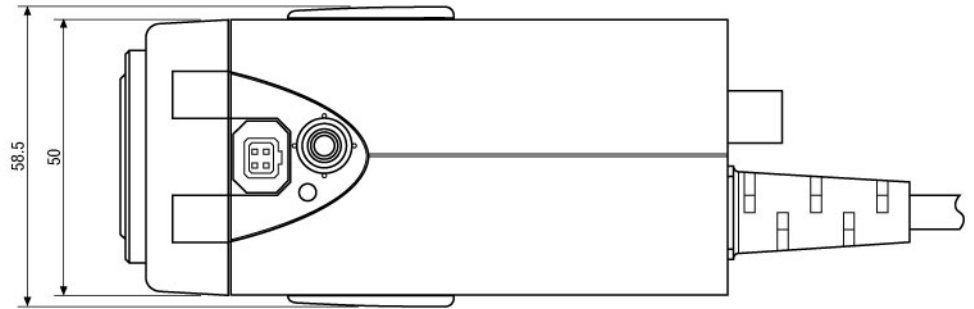
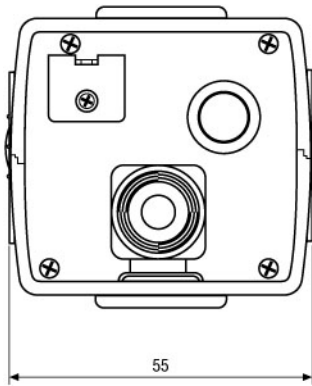

Maße/Dimensions: mm

SLD Security & Communications  
The Old Forge, Ockham Lane, Ockham, Surrey GU236PH England  
Phone +44.1483225633 · Fax +44.1483225634  
sales@sld.co.uk · www.sld.co.uk

