

CG-801PA1V

Home | Security | Cameras | Boxed

CG-801PA1V
1/3" Day/Night Multifunction Camera with WDR, OSD,
DSS, 12VDC/24VAC, 540TVL

Art-Nr. 92509



Lens is not included

Main Features

Wide Dynamic Range (WDR):60dB (Sony SSIIIChip Set)
Removable IR Cut Filter w. "Detect Time"Function
On-screen Menu Control / Camera Titel Display
Sensitivity of 0.5Lux at F1.2 (Colour)
Scene Select Function (Inside, Outside, Casino)
Back Light Compensation (BLC) / Zone Masking

High- und Low-Speed Shutter Control (ESC/DSS)
Auto Blemish Compensation (up to 10 Pixels)
2.5x Digital Zoom and Flickerless Function
Automatic White Balance with Hold Function (AWB)
External Day/Night Selection / RS-485 Interface
Supply Voltage 12VDC or 24VAC

Specifications

Video standard	CCIR/PAL
System	day&night
Sensor size	1/3"
Imager	CCD, Sony Progressive Scan Interline Transfer
Active picture elements	440,000, 752(H) x 582(V)
Signal processing	Digital (DSP)
Synchronization	Internal/Line lock (via OSD menu)
Signal-to-noise ratio	50dB (AGC OFF)
Gamma correction	0.45/0.6/1.0
Horizontal resolution	540 TVL, (colour), 560 TVL (B&W)
Sensitivity (at 50% video signal)	0,5 Lux, at F1.2 (colour); 0.06Lux at F1.2 (B&W)
Electronic shutter control (ESC)	1/50 ~ 1/10,000sec.
Integration rate	yes
Dynamic range (WDR)	60db
Digital Noise Reduction (DNR)	no

CG-801PA1V

(Continuation Specifications)

Automatic gain control (AGC)	ON/OFF switchable (via OSD menu)
Backlight compensation	BLC, WDR, ON/OFF switchable (via OSD menu)
White balance (AWB)	Auto / Hold / Indoor (approx. 2800K), Outdoor (approx. 6000K), selectable via OSD menu
Blemish compensation	Automatic blemish detection and compensation (for up to 10 pixels)
Aperture Correction (APC)	Horizontal and vertical
Flickerless function	On/Off switchable (via OSD menu)
Complementary colour balance (WCCB)	Balances the difference of colour temperature between the high and low luminance area of the scene (ON/OFF switchable via OSD menu)
Switchable IR cut filter	yes
Window blanking	Up to 8 masking areas
OSD function control	OSD camera setup, WDR, DSS, Day/Night, E-Zoom, BLC, AWB, WCCB, AGC Sync., Flickerless, Masking (Window blanking)
Set-up via on-screen menu	Camera adjustments: Address, Baud rate, LED/OSD ON/OFF
Camera title display	Textinsertion via OSD menu
Motion Detection Function	Integrated
Lens mount	CS
Digital Zoom	1.5, 2.0, 2.5x (selectable via OSD menu)
Usable iris controls	Manual iris, DC controlled
External adjustments	Flange focus 4 menu cursor buttons, RS-485 termination ON/OFF
Video outputs (type)	CVBS, VBS
Video outputs	1Vp-p, (C)VBS, 75ohms, BNC
External connections	DC Iris (4-pin), Video (BNC), Power input, RS-485 interface
Serial interfaces	RS-485, Protocol: Pelco D
Camera mount	1/4" - 20 UNC thread on top and bottom
Supply voltage	12VDC, 24VAC, (+/-15%) 50Hz
Power consumption	approx. 4.7watts at 12VDC 6.5watts at 24VAC
Temperature range (Operation)	-10° ~+50°C
Dimensions (HxWxD)	See drawing
Colour	similar to RAL7048
Weight	200g
Parts supplied	4-pin plug, Remote Administration Software CD, Manual
Certificates	CE

Optional accessories

45246	YV5X2.7R4B-SA2L	F1.3/2.7-13.5mm DC Varifocal Lens, No Focus Shift, 1/3" CS Mount
43249	F07Z07NDDC-NFS	F1.3/7.5-50mm DC Lens/var. Focal Length with No Focus Shift, 1/3" CS Mount
77773	VT-PS12DCDT1	PSU 12VDC/1.0A, Regulated, Desktop Version, 1.8m Cables each w. open ends

CG-801PA1V

70495	VT-PS12DC-7	Plugable PSU w. Cont. & UK Mains plug-in 100-240VAC/12VDC-1.25A, Regulated
43238	F03Z2.710DC-NFS	F1.0/3-8mm DC Lens/var. Focal Length with No Focus Shift, 1/3"CS Mount
45251	YV10X5R4A-SA2L	F1,6/5-50mm DC Varifocal Lens with No Focus Shift, 1/3"CS Mount
47159	F0812M-NFS	F1.2/8mm Fixed Focal Length Lens with No Focus Shift, 1/3"CS Mount
43251	G04Z03NDDC-NFS	F1.2/4.5-12.5mm DC Lens/variable Focal Length, No Focus Shift, 1/2"CS Mount
47162	F0212M-NFS	F1.2/2.2mm Fixed Focal Length Lens with No Focus Shift, 1/3"CS Mount
70536	VT-PS12DC-9	Plug-in Power Supply Unit 100-240VAC 12VDC (1.0Amp), Regulated, w. open Ends
43237	F03Z04NDDC-NFS	F1.4/2.8-11mm DC Lens/var. Focal Length No Focus Shift, 1/3"CS Mount
43248	A04Z12NDDC-NFS	F1.2/4-12mm DC Lens/var. Focal Length with No Focus Shift, 1/2"CS Mount
70769	WD-22	Wall Mount Bracket with Ball Joint, 1/4"Camera Fixing Screw, Beige Grey
70771	WD-23	Wall Mount Bracket with Ball Joint, 1/4"Camera Fixing Screw, Pantone 877
47147	F0312NDDC-NFS	F1.2/2.8mm DC Lens with No Focus Shift, 1/3"CS Mount
47148	F0412NDDC-NFS	F1.2/4mm DC Lens with No Focus Shift, 1/3"CS Mount
47149	F0612NDDC-NFS	F1.2/6mm DC Lens with No Focus Shift, 1/3"CS Mount
43252	G04Z03M-NFS	F1.2/4.5-12.5mm Lens, Var. Focal Length with No Focus Shift, 1/2", CS Mount
43106	C/CS RING-AL	Adapter Ring, C/CS Mount, Aluminium anodized
74089	EDC-CR1	Converter RS-232/RS-485, Repeater RS-485
47156	F0312M-NFS	F1.2/2.8mm Fixed Focal Length Lens with No Focus Shift, 1/3"CS Mount
47157	F0412M-NFS	F1.2/4mm Fixed Focal Length Lens with No Focus Shift, 1/3"CS Mount
47158	F0612M-NFS	F1.2/6mm Fixed Focal Length Lens with No Focus Shift, 1/3"CS Mount
47161	F0212NDDC-NFS	F1.2/2.2mm DC Lens with No Focus Shift, 1/3"CS Mount
47154	F0812NDDC-NFS	F1.2/8mm DC Lens with No Focus Shift, 1/3"CS Mount
43239	A10Z04NDDC-NFS	F1.4/10-40mm DC Lens/var. Focal Length with No Focus Shift, 1/2"CS Mount

CG-801PA1V

Product information

The basis of the Fujitsu CG-801P is a Progressive Scan CCD. With this, it is not a matter of 50 half-images but 50 full images being read out per second in PAL. The dynamic range is now achieved by separate processing of the two full images of a frame, with which two separate exposure settings are involved. In the simplest case, the regulated diaphragm of a DC lens is responsible for the exposure of the darker parts of the image of the first frame, whilst a shutter is also used in addition for the light parts of the image of the second frame. The two images scanned by the Progressive Scan Sensor can now be exposed separately even without the use of a DC lens. One of the shutters of the camera is responsible for the light areas of the image, whilst the regulation of the DC diaphragm, or the second shutter of the SS3TM chip, ensures optimum exposure of the dark areas of the image. After this, both optimally exposed full images are merged to form one video picture. The integration of the latest SS3TM chip set from Sony, which is also used in the new Fujitsu CG-801P, results in a two-fold increase in photosensitivity. In addition, this change has resulted in improved WDR characteristics, which means that there is a marked increase in the dynamic range. The results are impressive. Over the course of many practical tests, we have so far been unable to create any scene having such an extreme lighting situation that the Fujitsu WDR model has been unable to cope. The RS-485 converter/recovery amplifier EDC-CR1 is recommended for configuration via PCs and for software updates.

CG-801PA1V

Home | Security | Cameras | Boxed

Technical drawing

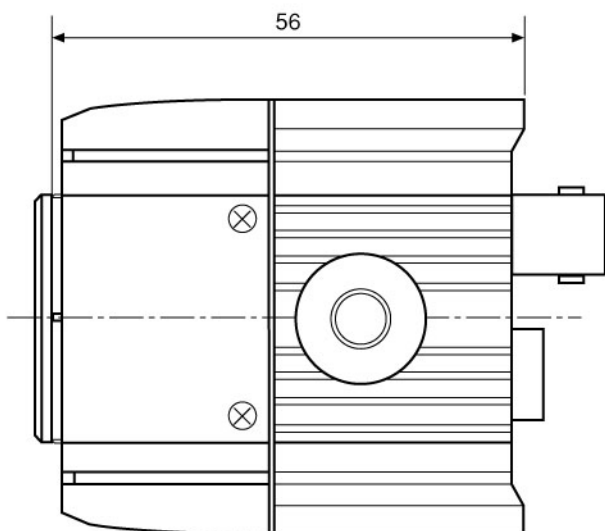
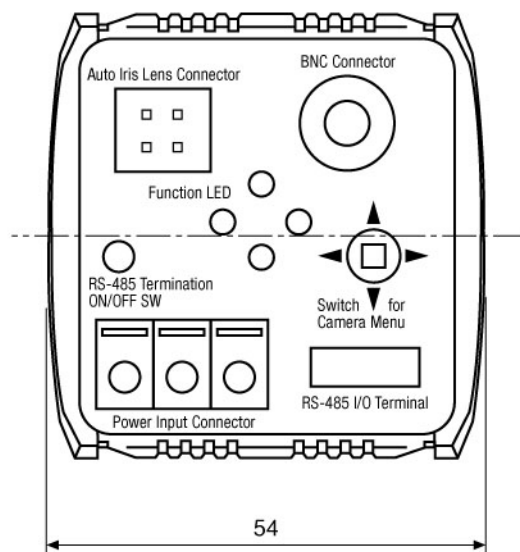
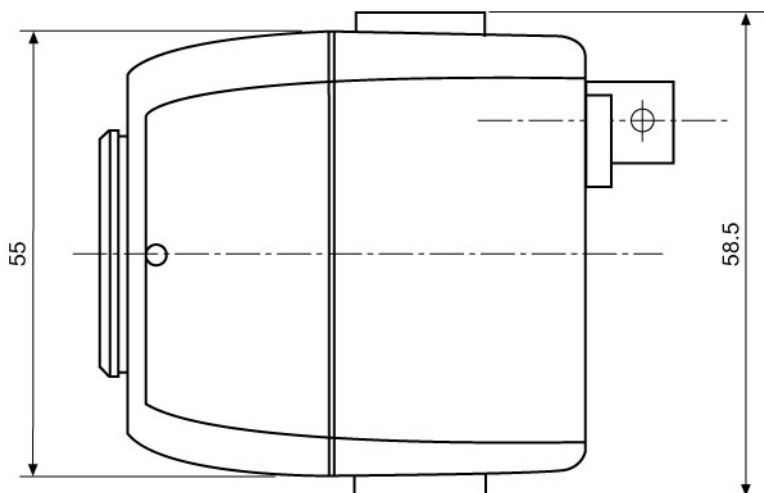

Maße/Dimensions: mm

SLD Security & Communications
The Old Forge, Ockham Lane, Ockham, Surrey GU236PH England
Phone +44.1483225633 · Fax +44.1483225634
sales@sld.co.uk · www.sld.co.uk

